

KEYNOTE LEGEND

- 1. PROP. STOP-BAR PER FDOT INDEX 711-001
- 2. PROP. WHITE DIRECTIONAL ARROWS PER FDOT INDEX 711-002
- 3. PROP. 25'-6" DOUBLE YELLOWS PER FDOT INDEX 711-001
- 4. PROP. 6" WHITE STRIPING PER FDOT INDEX 711-001
- 5. CROSSWALK STRIPING PER FDOT INDEX 711-001, 10 of 14
- 6. PROP. TYPE "F" CURB AND GUTTER IN ACCORDANCE WITH FDOT DESIGN STANDARDS 2020, AND FDOT INDEX 520-001
- 7. PROP. RELOCATED LIGHT POLE
- 8. MATCH EXISTING LINE AND GRADE
- 9. PROP. HANDICAP RAMP TYPE CR-G, PER FDOT 2020 INDEX 522-002, 4 OF 8
- 10. PROP. DETECTABLE WARNING PER FDOT INDEX 522-002, 6 OF 8, B
- 11. PROP. BICYCLE MARKING PER FDOT INDEX 711-002
- 12. PROP. 5' WIDE BICYCLE LANE
- 13. EXIST. 6" WHITE STRIPING
- 14. PROP. 6" WHITE 2'-4" SKIPS PER FDOT INDEX 711-001
- 15. PROP. 6" THICK CONCRETE SIDEWALK
- 16. EXIST. 40 MPH SPEED LIMIT SIGN (TO BE RELOCATED)
- 17. EXIST. STOP SIGN (TO BE RELOCATED)
- 18. SAFE SIGHT TRIANGLE PER FDOT DESIGN MANUAL 2020 CHAPTER 212.11, EXHIBIT 212-6
- 19. EXIST. MARKINGS TO BE REPLACED IN ACCORDANCE WITH FDOT DESIGN STANDARDS

| STRUCTURE TABLE | | | |
|------------------|---|---------------|-----------------------------------|
| STRUCTURE NUMBER | STRUCTURE TYPE | RIM ELEVATION | INVERT ELEVATION |
| EX-1 | EXISTING CATCH BASIN | 12.00 | (15') 3.59 (W) |
| S-21 | PROP. 48" DRAINAGE MANHOLE PER FDOT STND PLANS, CONTRACTOR TO CORE DRILL AND CONNECT PROP. 18" HDPE STORM PIPE | 11.00 M.E. | (15') 3.59 (E) (18') 3.59 (NW) |
| S-22 | PROP. 48" CATCH BASIN AND TYPE "C" FRAME, AND GRATE PER FDOT STND PLANS 425-052 WITH TYPE II SKIMMER PER FDOT STND PLAN INDEXES 232 & 241 | 11.30 | (18') 3.59 (SE) (18') 3.59 (N) |
| S-23 | PROP. 48" CATCH BASIN AND TYPE "C" FRAME, AND GRATE PER FDOT STND PLANS 425-052 WITH TYPE II SKIMMER PER FDOT STND PLAN INDEXES 232 & 241 | 12.30 | (18') 3.59 (S) |

SITE SYMBOLS /LEGEND

- (S) STOP SIGN, R1-1, 36"X36"
- (RO) RIGHT TURN ONLY, R3-5R, 30" X 36"
- (YB) YIELD TO BIKES, R4-4, 36" X 30"
- (SL) SPEED LIMIT 40 R2-4, 18" X 24"
- (BL) BIKE LANE R3-17
- PROPOSED SOLID DIRECTIONAL ARROW
- (E.P.) EDGE OF P.V.M.T. ELEV. OR GROUND ELEV.
- PROP. FLOW DIRECTION
- EXIST. GRADE ELEVATION

HATCH LEGEND

- PROPOSED CONCRETE SIDEWALK
- PROPOSED NEW PAVEMENT, CONTRACTOR SHALL MATCH EXISTING PAVEMENT PER FDOT STANDARDS SPECIFICATIONS

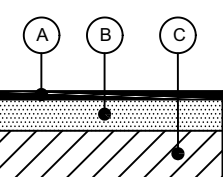

- A 3' OPTIONAL BASE GROUP 9 (OBG9), ASPHALT SHALL BE PLACED IN TWO (2) LIFTS: 2" OF SP-12.5 AND 1" OF SP-9.5
- B 12" CRUSHED LIMESTONE BASE COURSE HAVING A MINIMUM LBR OF 100 AND MINIMUM CARBONATE CONTENT 70%
- C TYPE B OR C, 12" STABILIZED SUB-GRADE FILLED WITH MINIMUM LBR OF 40 COMPACTED TO AT LEAST 98% OF THE MODIFIED PROCTOR MAXIMUM DRY DENSITY PER ASTM D-1557, PLACED IN (2) LIFTS, PER MG. PW.

FDOT PAVEMENT DETAIL

SCALE: N.T.S.

PAVEMENT NOTE:

ANY PAVEMENT MARKINGS DAMAGED DUE TO CONSTRUCTION WILL BE REPLACED AT CONTRACTOR'S EXPENSE.

ELEVATIONS NOTE:

ELEVATIONS ARE RELATIVE TO THE NORTH AMERICAN VERTICAL DATUM OF 1988 (NAVD88) AND ARE BASED ON THE BROWARD COUNTY BENCHMARK #260/2752C. REFER TO BOUNDARY AND TOPOGRAPHIC SURVEY CONDUCTED BY MILLER LEGG.

ADA NOTE:

CONSULTANT HAS IDENTIFIED AND USED THE CURRENT VERSION OF ALL LOCAL, STATE, AND FEDERAL ACCESSIBILITY GUIDELINES FOR SITE ACCESSIBILITY. THE SITE HAS BEEN DESIGNED IN ACCORDANCE WITH, BUT NOT LIMITED TO, CITY, COUNTY, AND STATE ACCESSIBILITY CODES, AND THE 2010 AMERICANS WITH DISABILITIES ACT STANDARDS FOR ACCESSIBLE DESIGN (2010 ADA STANDARDS), AS AMENDED.

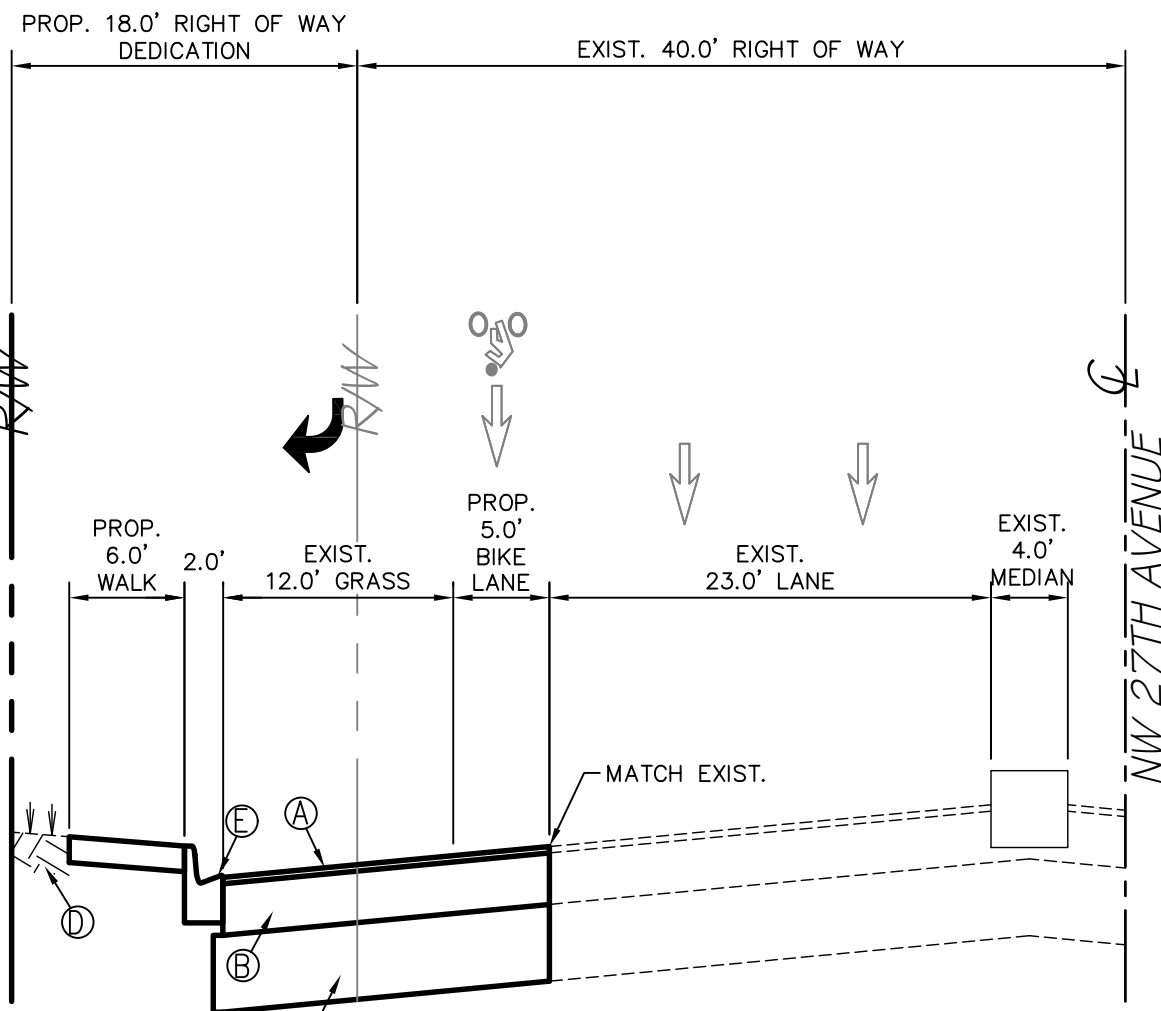

- PROP. 3" ASPHALT PAVEMENT SURFACE (SEE DETAIL, THIS SHEET)
- PROP. 12" BASE COURSE (SEE DETAIL, THIS SHEET)
- PROP. 12" STABILIZED SUBGRADE (SEE DETAIL, THIS SHEET)
- EXIST. SOLID SOD
- PROP. TYPE "F" CURB & GUTTER

**NW 27TH AVENUE
PROPOSED TURN LANE CROSS SECTION "A"-A"**

SCALE: HOR. 1" = 10'

VERT. 1" = 4'

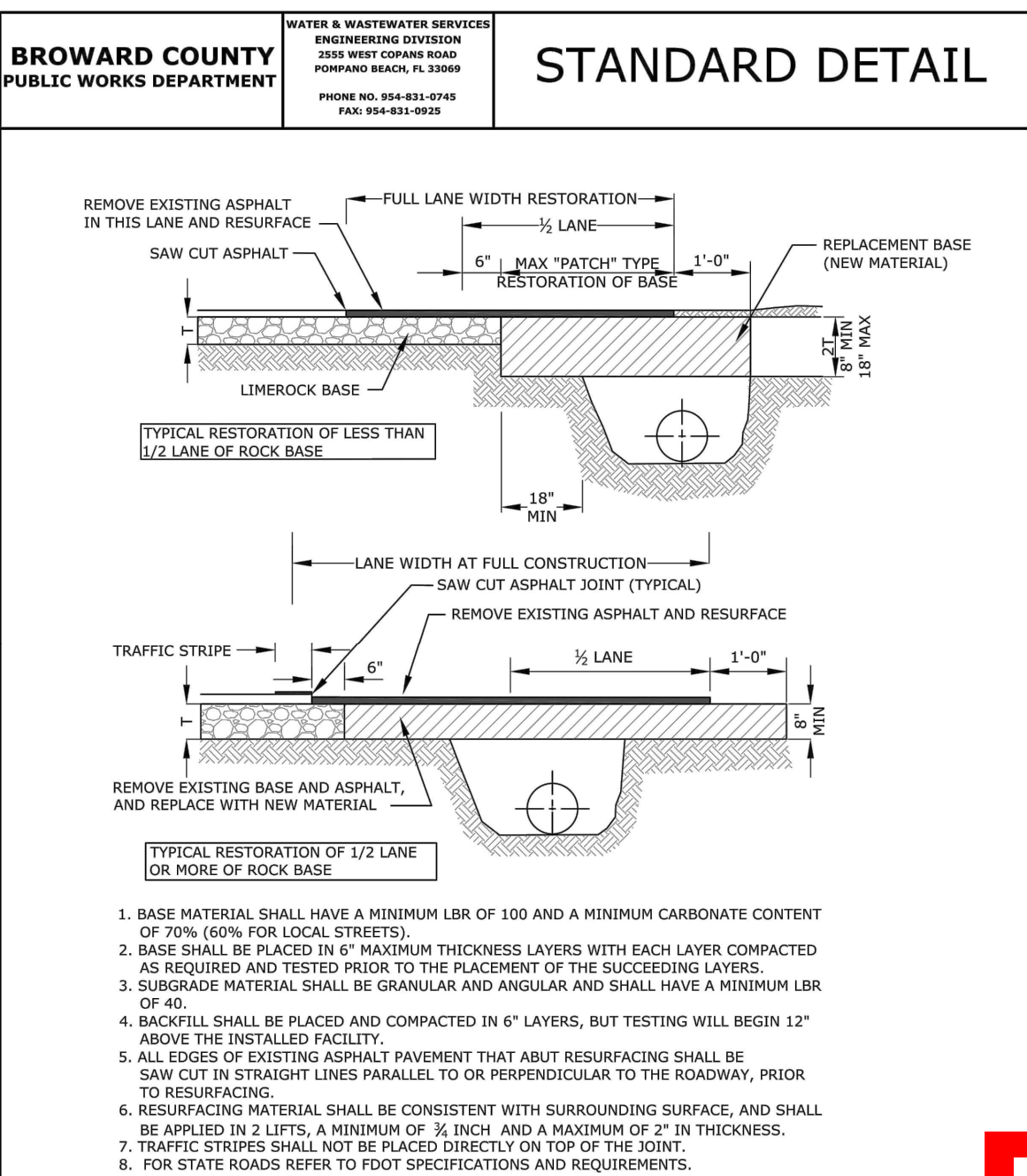

REPLACES FORMER
DWG NO. 19A
REVISED
2/23/2011

RESTORATION OF ROADWAY CUT
FOR
PARALLEL UTILITY INSTALLATION

FIGURE
182

B.C.H.C.E.D. REF. NO. 200617002



696 N.E. 125th STREET
NORTH MIAMI, FL 33161
Phone: 305.720.2079
C.O.A. 33221

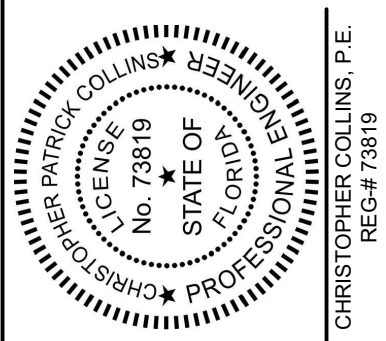

This Item has been digitally signed and sealed by Christopher P. Collins, P.E. on the date adjacent to the seal.

Printed copies of this document are not considered signed and sealed and the signature must be verified on any electronics copies.



Christoph Collins
Digitally signed by Christopher Collins
Date: 2022.07.14 12:36:01 -05'00'

| Revision | Date | Comment |
|----------|------|---------|
| | | |
| | | |
| | | |
| | | |
| | | |
| | | |
| | | |
| | | |
| | | |

Designed by: C.P.C.
Drawn by: A.T.S.
Checked by: C.P.C.
Approved by: C.P.C.
Scale: 1" = 20'
Date: 05/25/2022
Job No.: I002

Plans for
FESTIVAL MARKETPLACE
2900 W SAMPLE ROAD
POMPAHO BEACH, FLORIDA

**NW 27TH AVENUE
TURNLANE
BLOW UP
PLAN**

Call 8... visit sunshin...
Sunshine...
Check positive responses codes before you dig!

DRC
PZ22-12000027
10/5/2022

PZ22-12000027
8/17/2022